

Parts - Model 295616

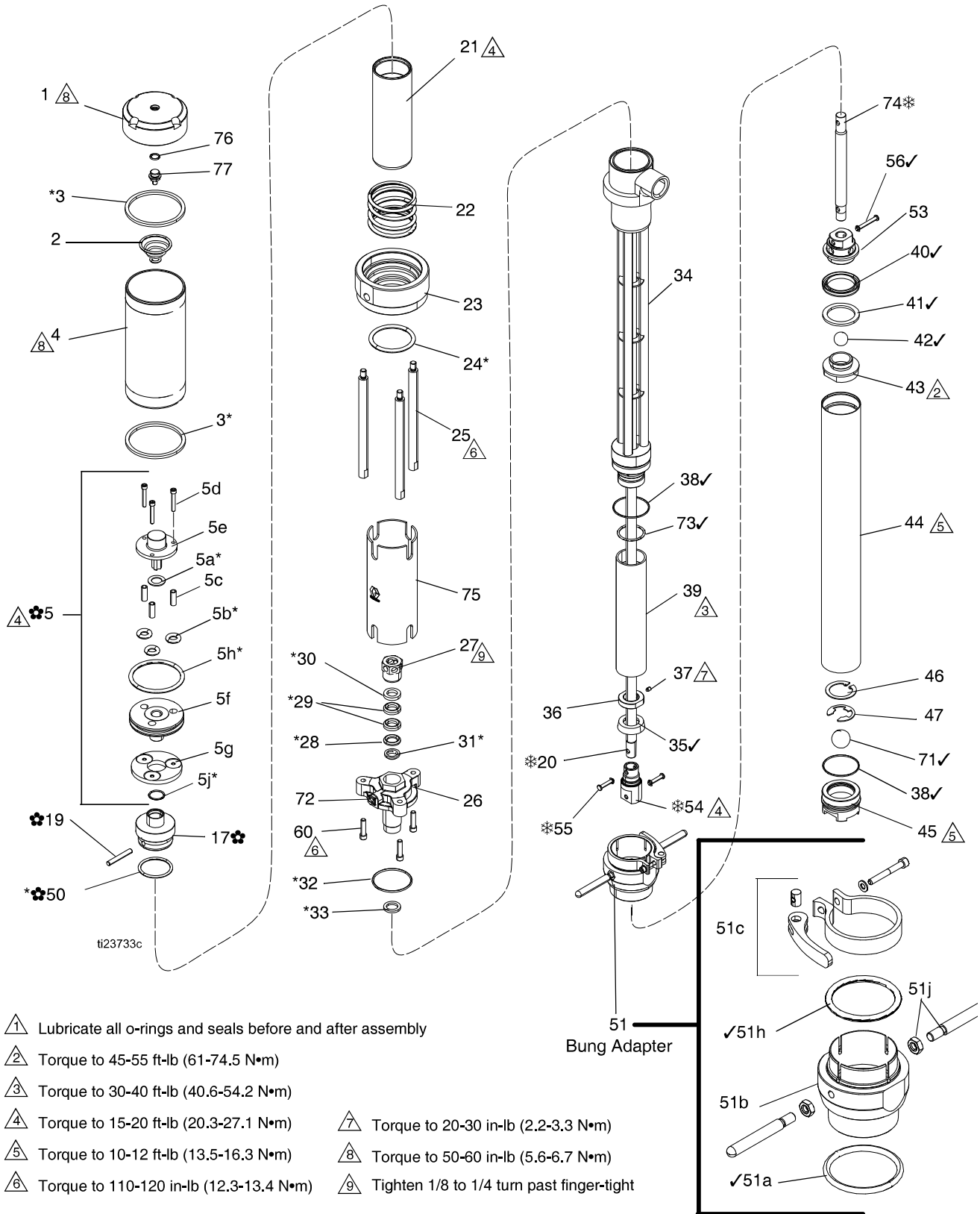

- △1 Lubricate all o-rings and seals before and after assembly
- △2 Torque to 45-55 ft-lb (61-74.5 N•m)
- △3 Torque to 30-40 ft-lb (40.6-54.2 N•m)
- △4 Torque to 15-20 ft-lb (20.3-27.1 N•m)
- △5 Torque to 10-12 ft-lb (13.5-16.3 N•m)
- △6 Torque to 110-120 in-lb (12.3-13.4 N•m)
- △7 Torque to 20-30 in-lb (2.2-3.3 N•m)
- △8 Torque to 50-60 in-lb (5.6-6.7 N•m)
- △9 Tighten 1/8 to 1/4 turn past finger-tight

Ref	Part	Description	Qty	Ref	Part	Description	Qty
1‡	16V524	CAP, air cylinder	1	51c	234188	CLAMP, hopper	1
2‡	157630	SPRING, tapered	1	51h✓	120207	O-RING; inner (brown)	1
3‡*	120212	PACKING, square	2	51J	26A699PKG	HANDELS with jam nut	1
4	24J528	CYLINDER, air motor	1	52†	114558	COUPLER, air line	1
5☼	262035	VALVE, air	1	53	15J570	HOUSING, piston	1
5a*	15J539	GASKET, upper	1	54*		PISTON, upper	1
5b*	121889	O-RING	3	55✓*	120294	PIN, clevis, 3/16 in. x 3/4 in.	2
5c	15J544	SPACER	3	56✓	120295	PIN, clevis, 3/16 in. x 1-1/4 in.	1
5d	121610	SCREW	3	60	120348	SCREW, cap, socket head 1/4-20 x 1 in. (25 mm)	3
5e	16U730	CAP, air, valve	1	69†	15H197	TOOL, pin	2
5f	15V554	HEAD, air valve	1	70†	15K008	LABEL, material identification.	1
5g	15J546	DISK, air valve	1	71✓	107167	BALL, intake, sst, 1 in. (25 mm)	1
5h*	160258	O-RING	1	72	116343	SCREW, ground	1
5j*	722834	O-RING	1	73✓	113944	O-RING	1
17☼		CAP, air piston	1	74*		SHAFT, transfer, lower	1
19☼	15J548	PIN, dowel	1	75	24V858	GUARD	1
20*		SHAFT, transfer	1	76‡	111819	O-RING	1
21	24J535	PISTON, air	1	77‡	16V523	PIN, spring stop	1
22	15J551	SPRING, compression	1				
23	24J529	BASE, air motor	1				
24*	159846	O-RING (green)	1				
25	15J553	ROD, tie	3				
26	24J530	FLANGE, mounting	1				
27	15J555	NUT, hex	1				
28*	15J556	GLAND, packing, (male)	1				
29*	15J557	V-PACKING, PTFE	2				
30*	15J558	GLAND, packing, (female)	1				
31*	15J559	WIPER, ROD	1				
32*	15C638	O-RING, PTFE, encapsulated	1				
33*	15J560	GASKET, PTFE	1				
34	24J536	BODY, pump, 2:1	1				
35✓	15J562	PACKING, piston cup	1				
36	15J563	COLLAR, retaining	1				
37	101194	SCREW, set, socket head, 10-32 x .25 in. (6 mm)	1				
38✓★	106258	O-RING	2				
39	24J534	CYLINDER, fluid	1				
40✓	15J565	PACKING, u-cup, PTFE	1				
41✓	15J566	RING, wear	1				
42✓	103462	BALL, outlet, sst, 3/4 in. (19 mm)	1				
43	24J531	VALVE, piston	1				
44	24J532	TUBE, suction	1				
45	24J533	VALVE	1				
46	120734	RING, retaining, internal	1				
47	120735	RING, snap, e series	1				
48†	206264	VALVE, needle	1				
49†	169969	FITTING, air line	1				
50*☼	108832	O-RING	1				
51	253146	ADAPTER, bung (includes 51a-51g)	1				
51a✓	120998	O-RING, fluoroelastomer	1				
51b	-----	ADAPTER	1				

* *Parts included in Upper Seal Repair Kit 262034 (not sold separately).*

✓ *Parts included in Lower Seal Repair Kit 247883.*
NOTE: Seal Repair Kit 24X056 includes all parts in kit 262034 and kit 247883. The spring pins (55, 56) originally supplied in series A and B pumps have been upgraded to a solid clevis pin for improved reliability.

* *Parts included in repair kit 256560*
NOTE: The pump shaft originally supplied in series A pumps has been upgraded to a multi-piece assembly for better sealing and serviceability. Pumps can be upgraded with repair kit 256560.

☼ *Parts included in repair kit 262042*
NOTE: The air valve originally supplied in series A pumps can be upgraded with kit 262042.

† *Indicates parts not shown, 48, 49, 52, 69, 70 (shipped loose)*

★ *O-rings included in Tube Extension Kit 24N451.*

‡ *Parts included in air cap 24T043*
NOTE: The cylinder cap has been upgraded with spring stop for improved reliability. Existing pumps can be upgraded with Kit 24T043.

The T2 can be adapted for use in 250 gallon (946 liter) totes. Tube Extension 24N451 increases the length by 6.25 in. (165 mm) to reach material in the bottom of larger totes.