

Parts

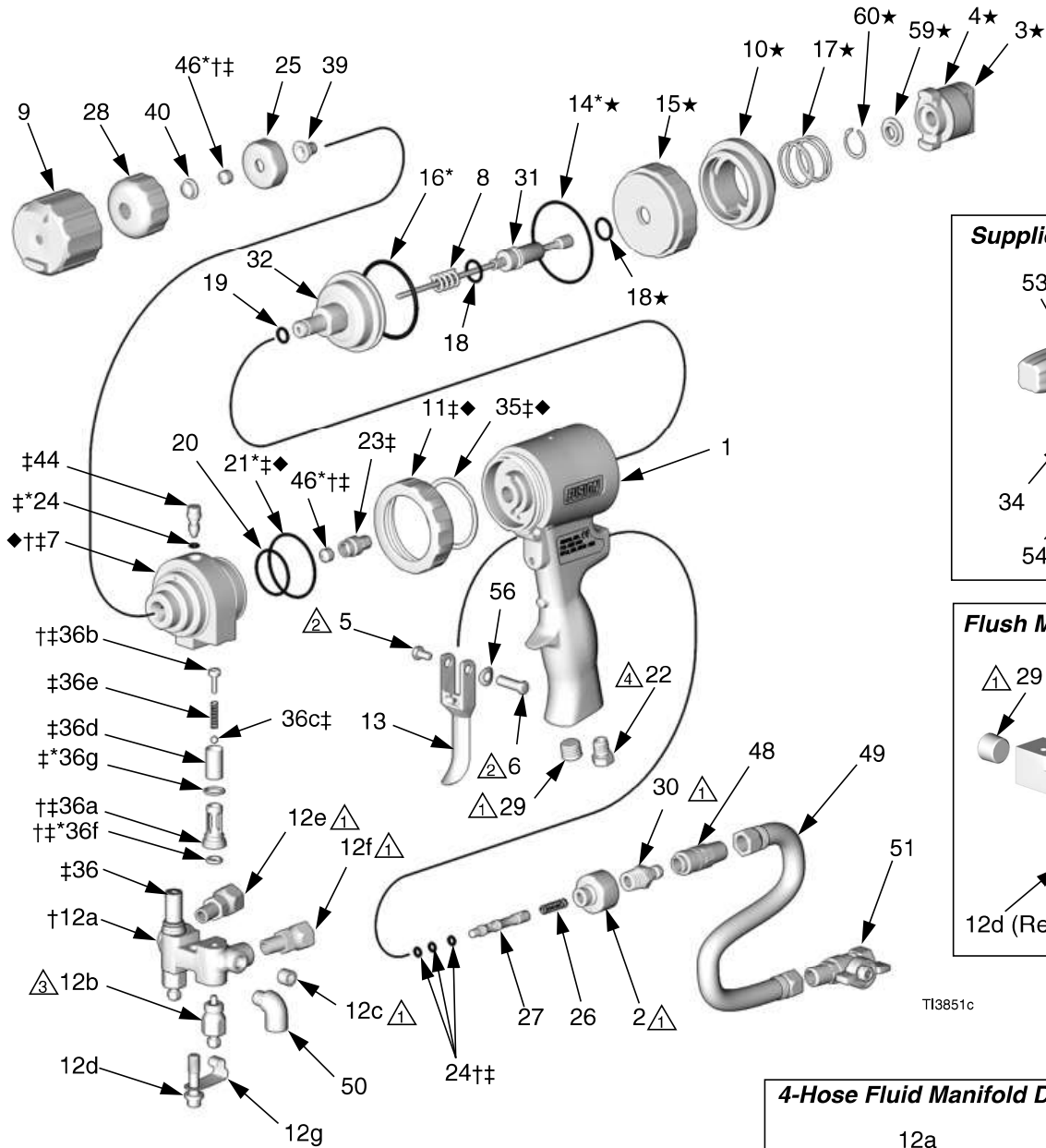

- Torque to 125-135 in-lb (14-15 N•m).
- Torque to 20-30 in-lb (2.3-3.4 N•m).
- Torque to 32-40 ft-lb (43-54 N•m).
- Torque to 35-45 in-lb (4-5 N•m).

Supplied Tools

TI3870a

Flush Manifold Detail

TI2647a

4-Hose Fluid Manifold Detail

TI7134A

Ref. No.	Part No.	Description	Qty	Ref. No.	Part No.	Description	Qty
1	248002	HANDLE	1	36†	246731	VALVE, check, A side; includes 36a-36g	1
2	15B208	PLUG, air valve	1		246352	VALVE, check, B side; includes 36a-36g	1
3★	15C374	ACTUATOR; safety	1			HOUSING	1
4★	15C390	BUSHING, safety	1	36a††			1
5	203953	SCREW; 10-24 x 3/8 in. (10 mm)	1	36b††	15B214	SCREW; 5/16-18 x 1/2 in. (13 mm)	1
6	192272	PIN	1	36c†	104396	BALL; carbide	1
7††◆		HOUSING, fluid	1	36d†		SCREEN; see page 54	1
8	118145	SPRING, purge rod	1	36e†	117490	SPRING	1
9	15C375	AIR CAP	1	36f†*	248133	O-RING, check valve face; package of 6	1
10★	15C373	CAP, rear	1	36g†*	248129	O-RING, check valve housing; package of 6	1
11†◆	15B215	RING, lock	1	37▲	222385	TAG, warning; not shown	1
12	246012	MANIFOLD, fluid, 2-hose; includes 12a-12g	1	39		MODULE, mix, round, standard; see page 50	1
	249523	MANIFOLD, fluid, 4-hose; includes 12a, 12b, 12d-12g, 50	1			MODULE, mix, flat, standard; see page 50	1
12a†		MANIFOLD	1			MODULE, mix, round, direct impingement; see page 51	1
12b	246356	VALVE, fluid	2			MODULE, mix, flat, direct impingement; see page 51	1
12c	100139	PLUG, pipe; 1/8-27 npt	2	40		CeramTip; see page 52	1
12d	15B221	BOLT; 5/16-24	1	44†	15C382	VALVE, cleanoff air	1
12e	117634	SWIVEL, B side; 1/8 npt(m) x no. 6 JIC(f); for 2-hose manifold	1	46††*	248003	SEAL KIT, purge rod; includes 4 seals	1
	117634	SWIVEL, B side; 1/8 npt(m) x no. 6 JIC(f); for 4-hose manifold	2	48	117510	COUPLER, air line	1
12f	117635	SWIVEL, A side; 1/8 npt(m) x no. 5 JIC(f); for 2-hose manifold	1	49	15B772	HOSE, air; 1/4 npsm (fbe); 18 in. (0.46 m)	1
	117635	SWIVEL, A side; 1/8 npt(m) x no. 5 JIC(f); for 4-hose manifold	2	50	112307	ELBOW, street; 1/8 npt (m x f)	2
12g	15B993	SPRING, ring, lock	1	51	15B565	VALVE, ball; 1/4 npt (m x f)	1
13	15B209	TRIGGER	1	52	15B817	MANIFOLD, gun flush	1
14*★	248136	O-RING, rod stop; package of 6	1	53	117642	NUT DRIVER, hex; 5/16	1
15★	15C372	STOP, purge rod	1	54	118575	SCREWDRIVER; 1/8 blade	1
16*	248135	O-RING, piston; package of 6	1	55	197979	COVER, gun; not shown	1
17★	118144	SPRING, piston safety lock	1	56	15C480	WASHER, wave	1
18★	248095	O-RING, purge rod; package of 6	1	57■	118665	LUBRICANT, Fusion Gun; 4 oz (113 gram)	1
19	248096	O-RING, piston shaft; package of 6	1	58▲	15D235	SIGN, instruction	1
20	248138	O-RING, housing, small; package of 6	1	59★	15D329	STOP, rod	1
21†◆*	248132	O-RING, housing, large; package of 6	1	60★	115452	RING, retaining	1
22	119626	MUFFLER	1				
23†	15C378	NUT, rod seal, rear	1				
24†*	246354	O-RING; package of 6	1				
25	15C377	NUT, mix module	1				
26	117485	SPRING, air valve	1				
27	15B202	SPOOL, air valve	1				
28	15C376	RETAINER, CeramTip	1				
29	100721	PLUG, pipe; 1/4-18 npt	1				
30	117509	QUICK-DISCONNECT, male, air; 1/4 npt(m)	1				
31	248001	ROD, purge; includes 1 of item 18	1				
32	15C371	PISTON	1				
34	117661	WISE, pin; dual reversible chucks	1				
35†◆	116550	RING, retaining	1				

* These parts are only available in repair kits. To select a kit, refer to Gun Repair Kits on page 54.

† These parts are not available singly.

‡ These parts are included in Front End Replacement Kit 246875 (includes 1 of items 24 and 46).

★ These parts are included in Safety Stop Assembly 248028 (includes 1 of item 18).

▲ Replacement Danger and Warning labels, tags, and cards are available at no cost.

■ Available in 248279 Kit, package of 10. See page 55.

◆ Available in Fluid Housing Assembly Kit 248004.